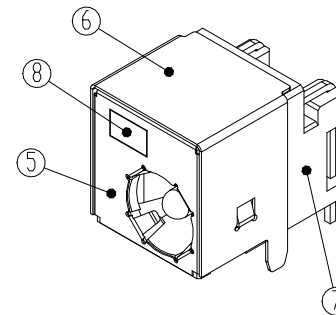

ADAPTATION PLUG

RoHS
Compliant

Level-1 Controlled Substances are banned

GREEN
8+ — 8- — 8-

SCHEMATIC

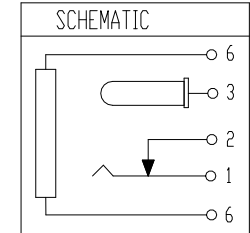

SPECIFICATION:

- VOLTAGE RATING: 24V & 5A
- CONTACT RESISTANCE: $\leq 30 \text{ m}\Omega$ (MAX)
- INSULATION RESISTANCE: $\geq 100 \text{ M}\Omega$ MIN.
- DIELECTRIC WITHSTANDING VOLTAGE: 500V/AC
- OPERATION TEMPERATURE: $-25^{\circ}\text{C} \sim +90^{\circ}\text{C}$
- WITHSTAND VOLTAGE: 500VAC
- INSERTION FORCE: $\leq 30 \text{ kgf}$ (MAX)
- EXTRACTION FORCE: $\geq 0.3 \text{ kgf}$ (MIN)
- LIFE TESTING: 5000 CYCLES
- SOLDERING PROCES: PARTS WILL WITHSTAND $260^{\circ}\text{C}/5\text{SEC}$
- MARKED \triangle ARE IMPORTANT DIMENSIONS

8	LED	1	—	GREEN	525nm WAVELENGTH
7	HOUSING	1	PA9T	BLACK	UL-94V0
6	SHELL 2	1	BRASS	BLACK	MATTE ZINC PLATING
5	SHELL 1	1	SUS301	BLACK	MATTE ZINC PLATING
4	TERMINAL 4	1	SUS301	—	—
3	TERMINAL 3	1	BRASS	—	Tin PLATING
2	TERMINAL 2	1	BRASS	—	Tin PLATING
1	TERMINAL 1	1	BRONZE	—	Tin PLATING
NO.	DESCRIPTION	QTY	MATERIAL	COLOR	REMARK

GENERAL TOLERANCE
UNLESS OTHERWISE NOTED

盛工电子有限公司

SHENG CONG ELECTRONIC CO.,LTD

General

Angle

CUSTOMER
COPY

TITLE:

DC POWER JACK

 $X \pm 0.50$ $X^{\circ} \pm 3^{\circ}$

PART NO.

DJ-D046

 $.X \pm 0.30$ $.X^{\circ} \pm 2^{\circ}$ $.XX \pm 0.20$ $.XX^{\circ} \pm 1^{\circ}$

PROJ:

SCALE: 2:1

UNIT:mm

SIZE: A4

SHEET: 1 OF 1

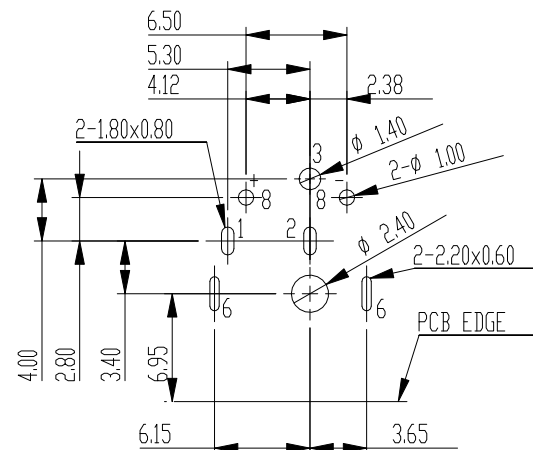
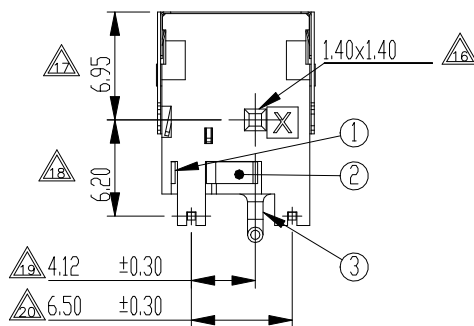
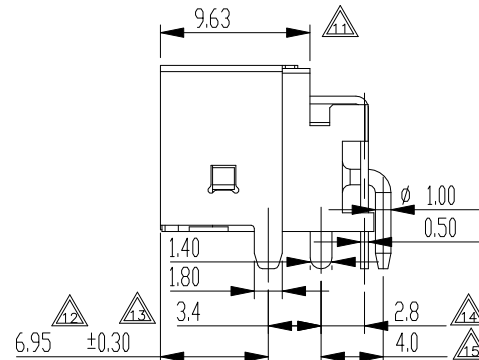
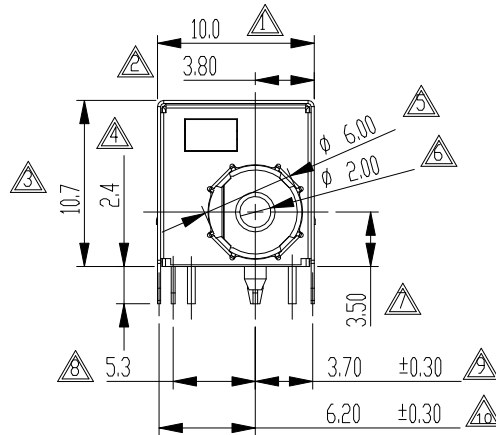
Dimensions of PC board holes
Top View Tolerance: $\pm 0.05 \text{ mm}$

						DESIGN	Jason	16'/03/21
						CHECK	Jason	16'/03/21
						APPRO.	Max.hu	16'/03/21
ECN(DCN) NO.	REV	DATE	DESCRIPTION	CHANGE	APPRO.			

Original Design: Jason Check: Jason Appro: Max.hu DATA: 16'/03/21